

**KEY:**

- Permanent changes
- Experimental changes
- No loading, waiting or stopping (12:00 - 20:00)

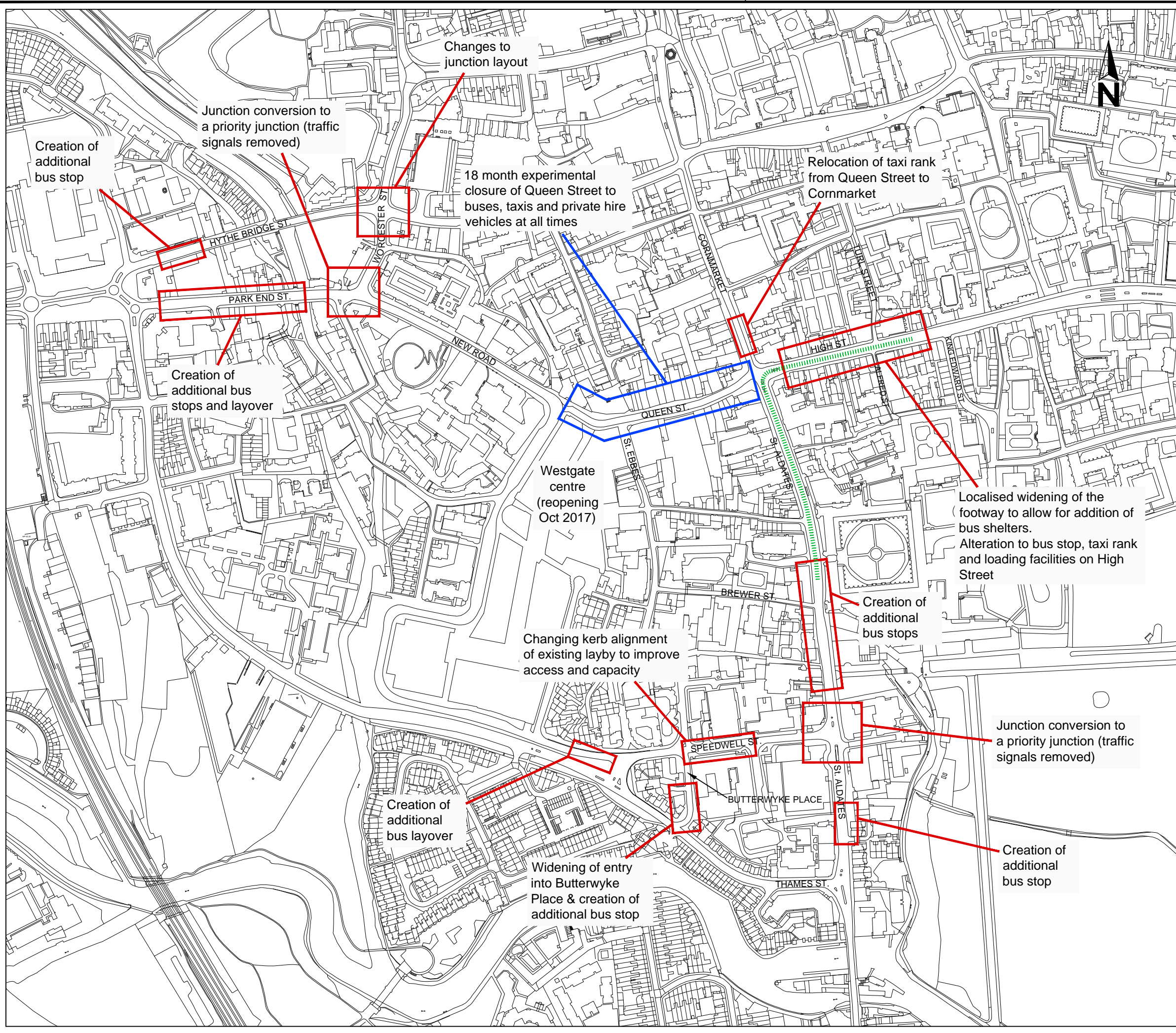

**SAFETY, HEALTH AND ENVIRONMENTAL INFORMATION**

IN ADDITION TO THE HAZARDS/RISKS NORMALLY ASSOCIATED WITH THE TYPES OF WORK DETAILED ON THIS DRAWING, NOTE THE FOLLOWING SIGNIFICANT RESIDUAL RISKS

CONSTRUCTION	(ENTER 'NONE' IF APPLICABLE)
MAINTENANCE/CLEANING	(ENTER 'NONE' IF APPLICABLE)
USE	(ENTER 'NONE' IF APPLICABLE)
DECOMMISSIONING/DEMOLITION	(ENTER 'NONE' IF APPLICABLE)

© Crown Copyright and Database rights 10023343 2017

Rev.	Date	Purpose of revision	Drawn	Checked	Approved



Owen Jenkins  
Director for  
Infrastructure Delivery  
Communities  
Oxfordshire County Council  
County Hall  
New Road  
Oxford  
OX1 1ND  
Tel: 0845 310 1111

Project title  
**Connections To Oxford Station**

Drawing title  
**Location Plan For Works Covered By This Scheme**

Drawing Status: Consultation

Scale @ A3	Drawn by SAC	Checked by	Approved by
NTS	Date drawn 11.05.17	Date checked	Date approved

P:\4. Improvement Schemes\Schemes\201320 Connections to Oxford Station\201320 Part 2 Feb 2017\07 Drawings\05 Working Drgs\201820-CON-000-001 (Hythe).dwg

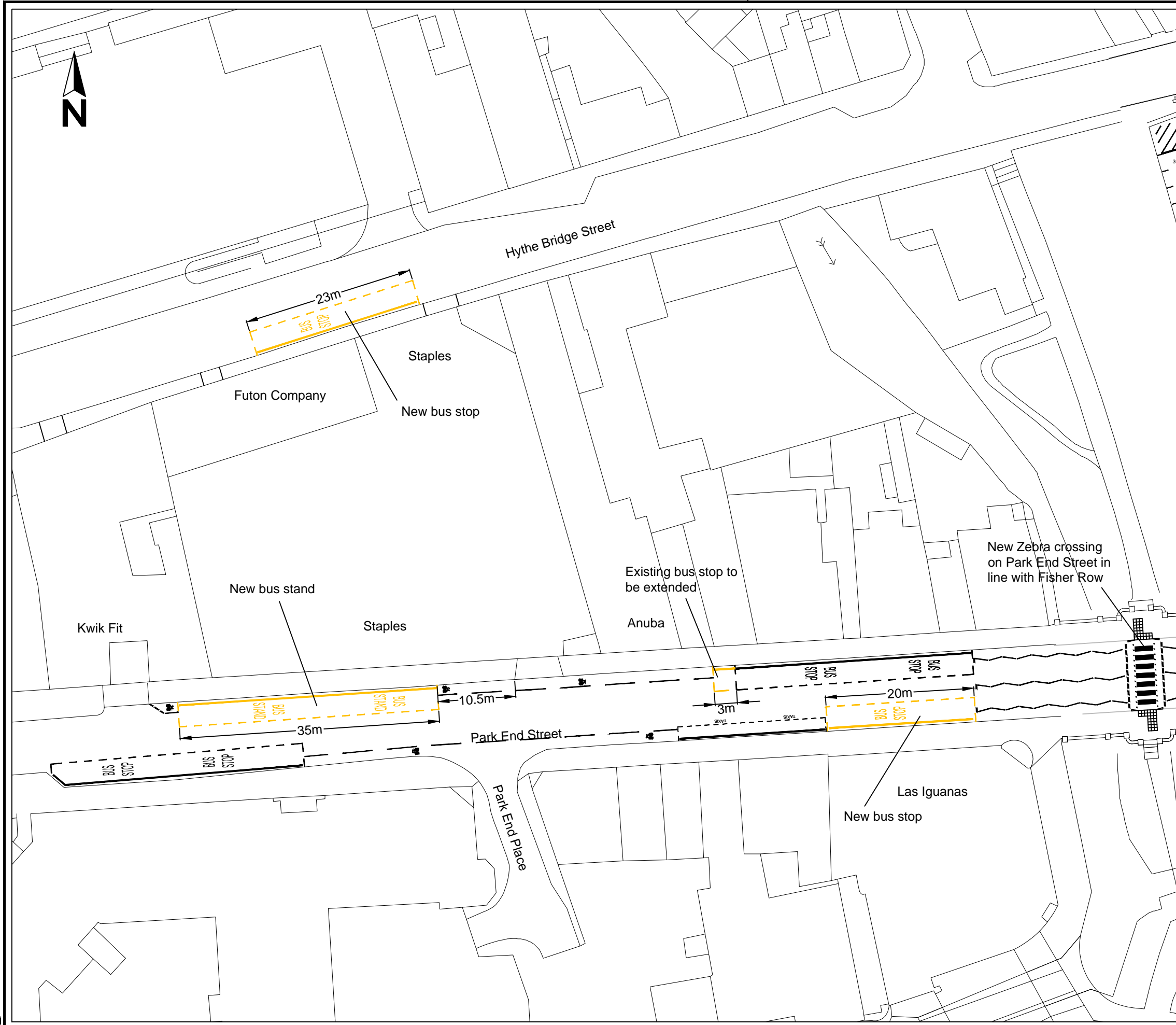

Drawing No. 201820/CON/000/001 Revision 0

**KEY:**  
 — Existing roadmarkings  
 — Proposed roadmarkings

**SAFETY, HEALTH AND ENVIRONMENTAL INFORMATION**

IN ADDITION TO THE HAZARDS/RISKS NORMALLY ASSOCIATED WITH THE TYPES OF WORK DETAILED ON THIS DRAWING, NOTE THE FOLLOWING SIGNIFICANT RESIDUAL RISKS

CONSTRUCTION	None - feasibility review stage only
MAINTENANCE/CLEANING	None - feasibility review stage only
USE	None - feasibility review stage only
DECOMMISSIONING/DEMOLITION	None - feasibility review stage only

© Crown Copyright and Database rights 10023343 2017

Rev.	Date	Purpose of revision	Drawn	Checked	Approved

**OXFORDSHIRE COUNTY COUNCIL**  
 Owen Jenkins  
 Director for Infrastructure Delivery  
 Communities  
 Oxfordshire County Council  
 County Hall  
 New Road  
 Oxford  
 OX1 1ND  
 Tel: 0845 310 1111

Project title  
 Connections to Oxford Station

Drawing title  
 Park End St / Hythe Bridge St  
 Additional Bus Facilities



Drawing Status Consultation

Scale @ A3	Drawn by SAC	Checked by EA	Approved by EA
1:500	Date drawn 27.04.17	Date checked 05.05.2017	Date approved 05.05.2017

Oxfordshire Project No. & File Ref  
 Drawing No. 201820/CON/000/001 Revision 0

P:\4. Improvement Schemes\201320 Connections to Oxford Station\201320 Part 2 Feb 2017\07 Drawings\05 Working Drgs\201820-CON-000-002 (Grey Friars).dwg

Drawing No. 201820/CON/000/002 Revision 0

**KEY:**  
 Existing roadmarkings  
 Proposed roadmarkings

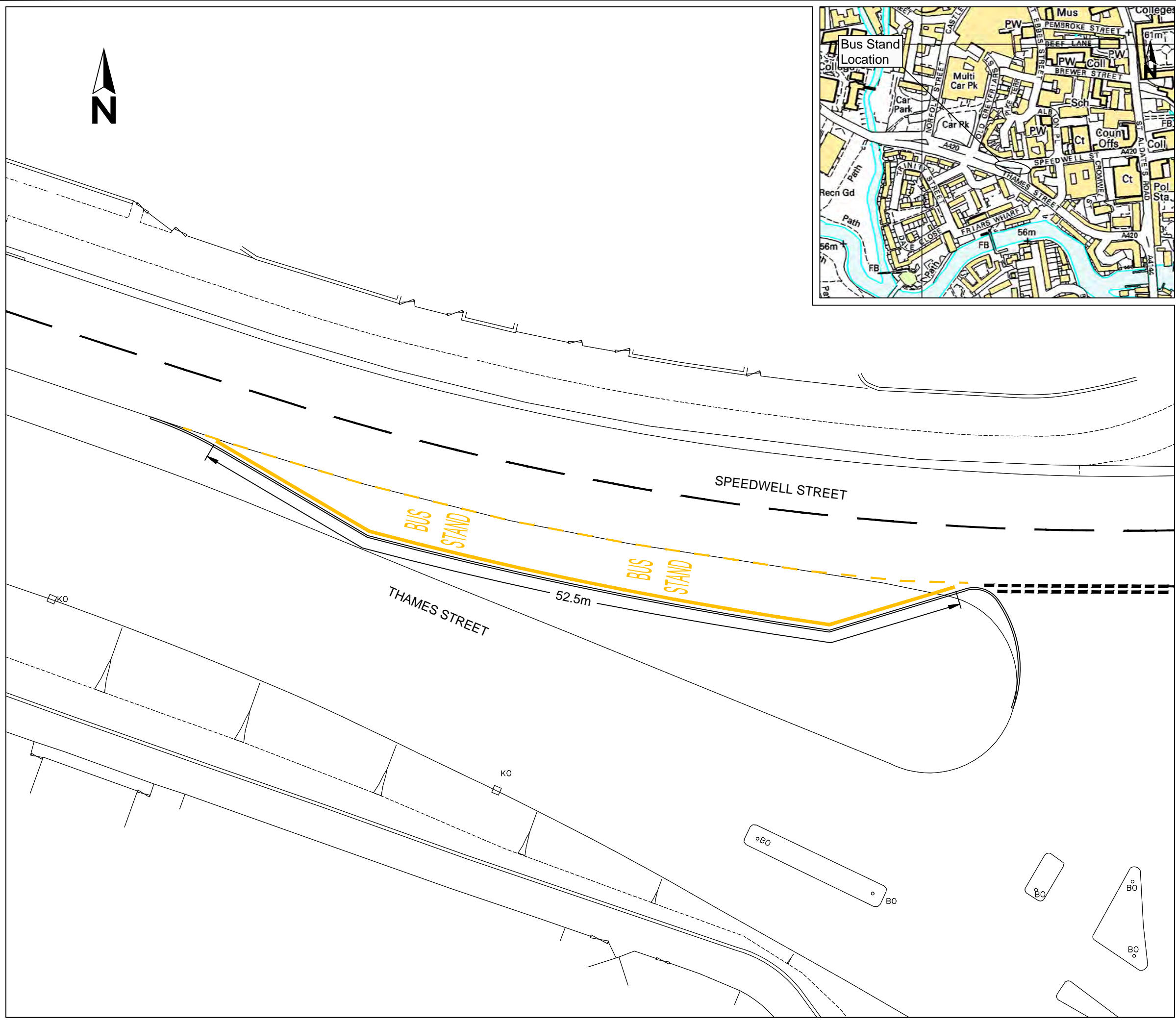
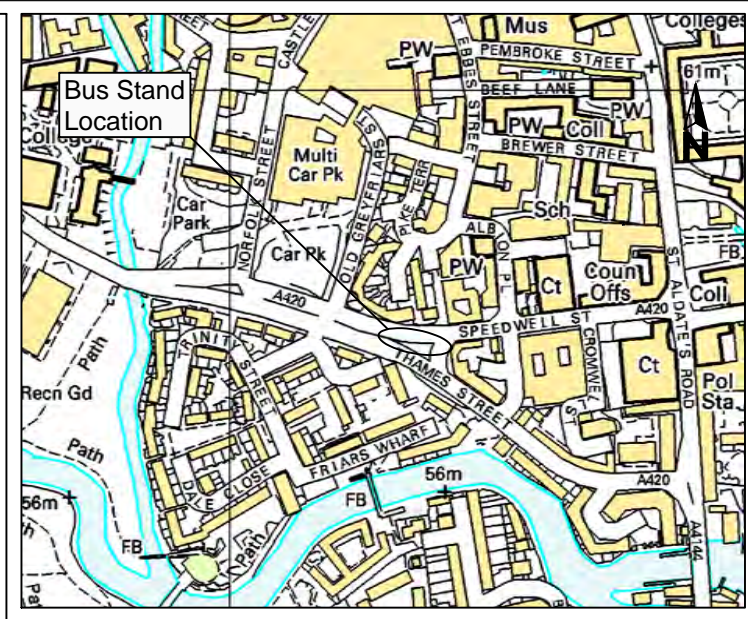

**SAFETY, HEALTH AND ENVIRONMENTAL INFORMATION**

IN ADDITION TO THE HAZARDS/RISKS NORMALLY ASSOCIATED WITH THE TYPES OF WORK DETAILED ON THIS DRAWING, NOTE THE FOLLOWING SIGNIFICANT RESIDUAL RISKS

CONSTRUCTION	None - Feasibility review stage only
MAINTENANCE/CLEANING	None - Feasibility review stage only
USE	None - Feasibility review stage only
DECOMMISSIONING/DEMOLITION	None - Feasibility review stage only

© Crown Copyright and Database rights 10023343 2017

Rev.	Date	Purpose of revision	Drawn	Checked	Approved



Owen Jenkins  
 Director for  
 Infrastructure Delivery  
 Communities  
 Oxfordshire County Council  
 County Hall  
 New Road  
 Oxford  
 OX1 1ND  
 Tel: 0845 310 1111

Project title  
**Connections to Oxford Station**

Drawing title  
**Bus Lay-Over Bay (2 bus length)  
 Speedwell Street  
 (Nr Old Grey Friars Street)**

Drawing Status Consultation

Scale @ A3	Drawn by SAC	Checked by EA	Approved by EA
1:250	Date drawn 4.5.17	Date checked 5.5.17	Date approved 5.5.17

Oxfordshire Project No. & File Ref

Drawing No. 201820/CON/000/002 Revision 0

P:\4. Improvement Schemes\Schemes\201320 Connections to Oxford Station\201320 Part 2 Feb 2017\07 Drawings\05 Working Drgs\201820-CON-000-003 (Speedwell).dwg

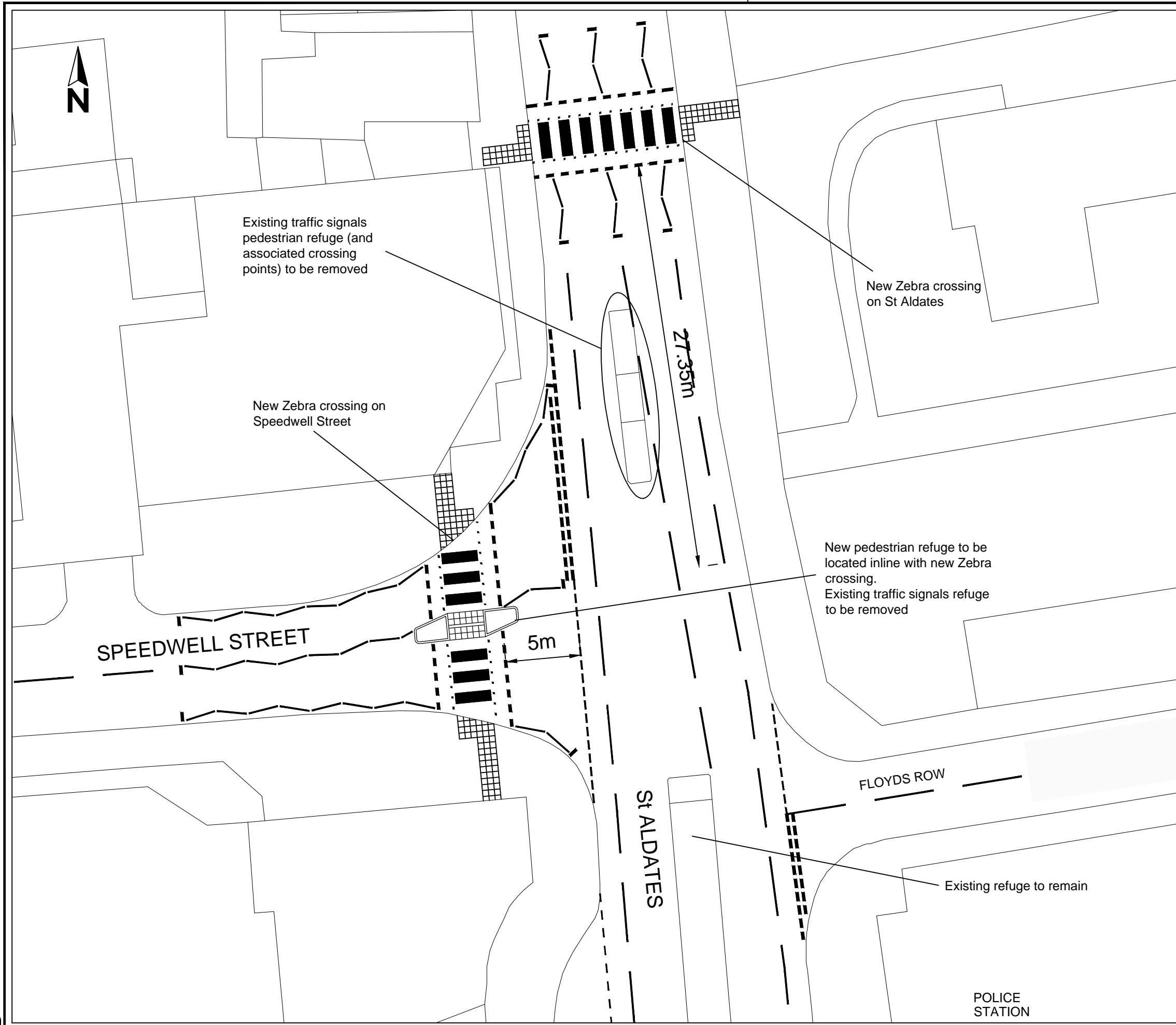

Drawing No. 201320/CON/000/003 Revision 0

**NOTES**

- Existing traffic signal control to be removed as part of the permanent changes to the junction layout..

**SAFETY, HEALTH AND ENVIRONMENTAL INFORMATION**

IN ADDITION TO THE HAZARDS/RISKS NORMALLY ASSOCIATED WITH THE TYPES OF WORK DETAILED ON THIS DRAWING, NOTE THE FOLLOWING SIGNIFICANT RESIDUAL RISKS

CONSTRUCTION	None - feasibility review stage only
MAINTENANCE/CLEANING	None - feasibility review stage only
USE	None - feasibility review stage only
DECOMMISSIONING/DEMOLITION	None - feasibility review stage only

© Crown Copyright and Database rights 10023343 2017

Rev.	Date	Purpose of revision	Drawn	Checked	Approved

Owen Jenkins  
Director for  
Infrastructure Delivery  
Communities  
Oxfordshire County Council  
County Hall  
New Road  
Oxford  
OX1 1ND  
Tel: 0845 310 1111

Project title  
Connections to Oxford Station

Drawing title  
Speedwell Street / St. Aldates  
Proposed Zebra Crossings

Drawing Status: Consultation

Scale @ A3	Drawn by SAC	Checked by EA	Approved by EA
1:250	Date drawn 04.05.2017	Date checked 05.05.2017	Date approved 05.05.2017

Oxfordshire Project No. & File Ref

Drawing No. 201320/CON/000/003 Revision 0

P:\4. Improvement Schemes\Schemes\201320 Connections to Oxford Station\201320 Part 2 Feb 2017\07 Drawings\05 Working Drgs\201320-CON-000-004 (PES).dwg

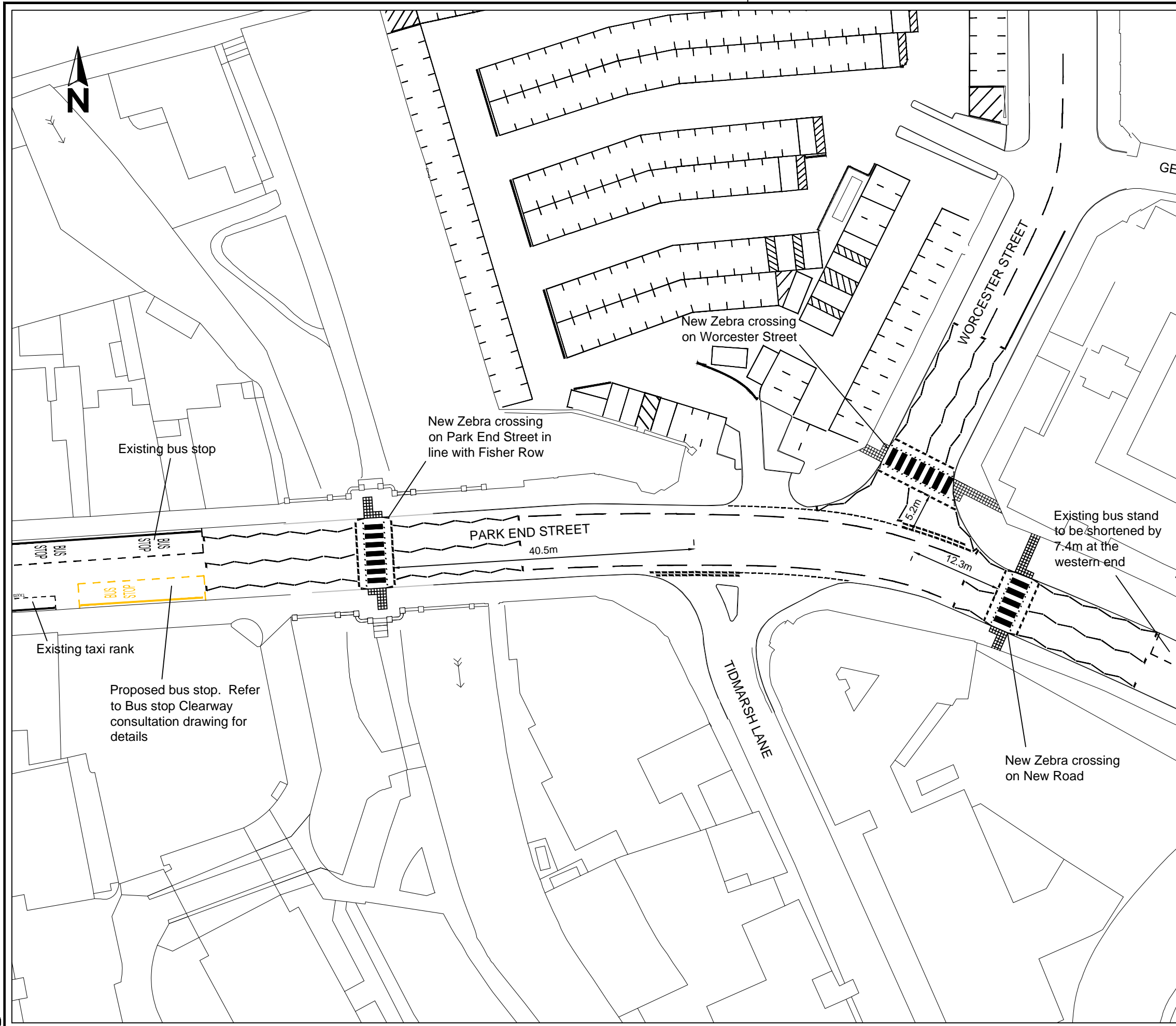

Drawing No. 201320/CON/000/004 Revision 0

**NOTES**

- Existing traffic signal control to be removed as part of the permanent changes to the junction layout..

**SAFETY, HEALTH AND ENVIRONMENTAL INFORMATION**

IN ADDITION TO THE HAZARDS/RISKS NORMALLY ASSOCIATED WITH THE TYPES OF WORK DETAILED ON THIS DRAWING, NOTE THE FOLLOWING SIGNIFICANT RESIDUAL RISKS

CONSTRUCTION	None - feasibility review stage only
MAINTENANCE/CLEANING	None - feasibility review stage only
USE	None - feasibility review stage only
DECOMMISSIONING/DEMOLITION	None - feasibility review stage only

© Crown Copyright and Database rights 10023343 2017

Rev.	Date	Purpose of revision	Drawn	Checked	Approved

**OXFORDSHIRE COUNTY COUNCIL**  
 Owen Jenkins  
 Director for Infrastructure Delivery  
 Communities  
 Oxfordshire County Council  
 County Hall  
 New Road  
 Oxford  
 OX1 1ND  
 Tel: 0845 310 1111

Project title  
**Connections to Oxford Station**

Drawing title  
**Park End St / New Rd / Worcester St  
 Proposed Zebra Crossings**

Drawing Status		Consultation	
Scale @ A3	Drawn by SAC	Checked by EA	Approved by EA
1:500	Date drawn 04.05.2017	Date checked 05.05.2017	Date approved 05.05.2017

Oxfordshire Project No. & File Ref

Drawing No. 201320/CON/000/004 Revision 0

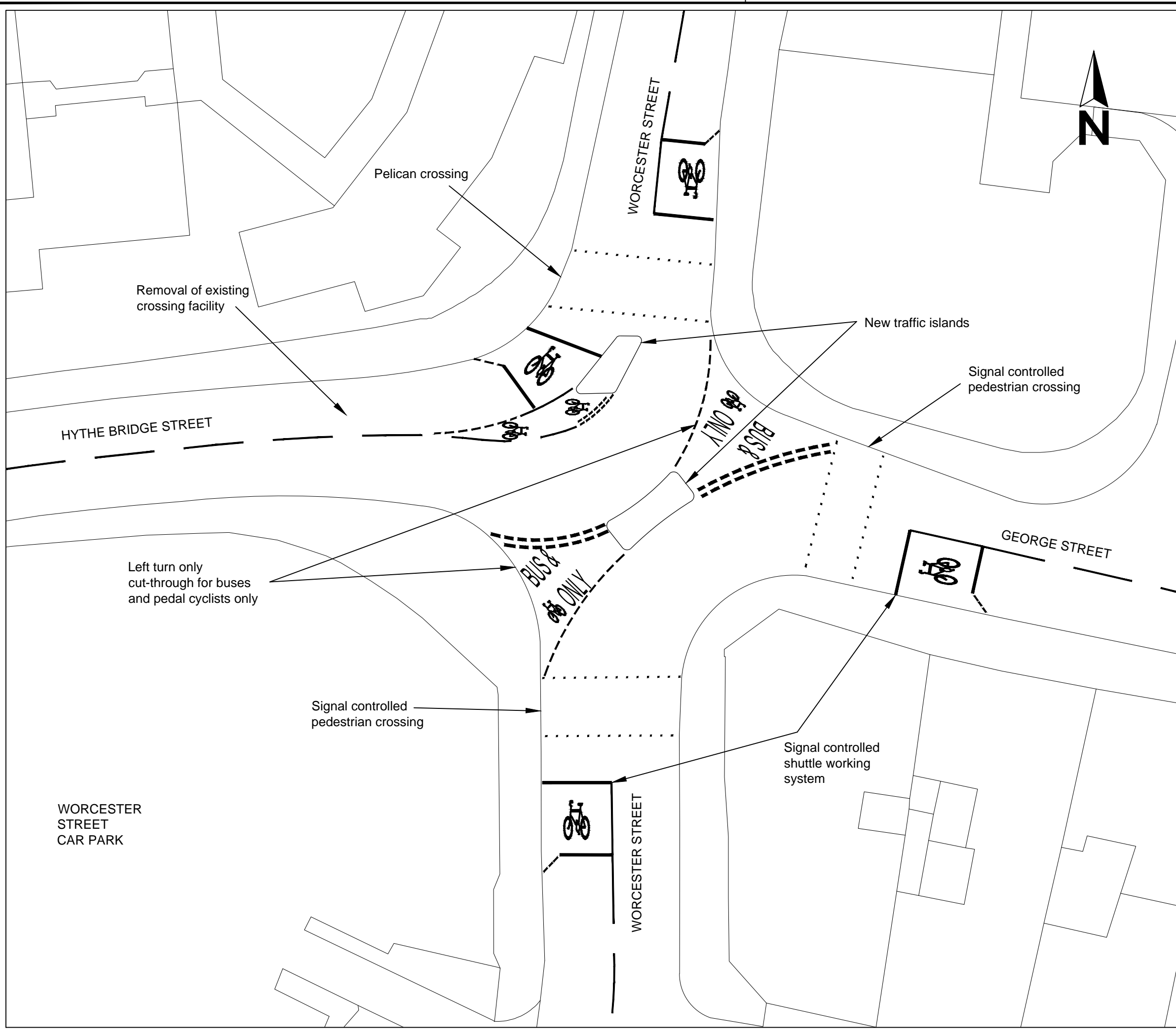

**SAFETY, HEALTH AND ENVIRONMENTAL INFORMATION**

IN ADDITION TO THE HAZARDS/RISKS NORMALLY ASSOCIATED WITH THE TYPES OF WORK DETAILED ON THIS DRAWING, NOTE THE FOLLOWING SIGNIFICANT RESIDUAL RISKS

CONSTRUCTION	(ENTER 'NONE' IF APPLICABLE)
MAINTENANCE/CLEANING	(ENTER 'NONE' IF APPLICABLE)
USE	(ENTER 'NONE' IF APPLICABLE)
DECOMMISSIONING/DEMOLITION	(ENTER 'NONE' IF APPLICABLE)

© Crown Copyright and Database rights 10023343 2017

Rev.	Date	Purpose of revision	Drawn	Checked	Approved



Owen Jenkins  
Director for  
Infrastructure Delivery  
Communities  
Oxfordshire County Council  
County Hall  
New Road  
Oxford  
OX1 1ND  
Tel: 0845 310 1111

Project title  
**Connections To Oxford Station**

Drawing title  
**George Street / Worcester Street  
Proposed Junction Layout Amendments**

Drawing Status: Consultation

Scale @ A3	Drawn by	Checked by	Approved by
1:250	SAC	Date checked	Date approved
		11.05.17	

**NOTES**

- Layout based on Ordnance Survey base mapping data and will be subject to further site verification should the project proceed.

SAFETY, HEALTH AND ENVIRONMENTAL INFORMATION		
IN ADDITION TO THE HAZARDS/RISKS NORMALLY ASSOCIATED WITH THE TYPES OF WORK DETAILED ON THIS DRAWING, NOTE THE FOLLOWING SIGNIFICANT RESIDUAL RISKS		
CONSTRUCTION		
None - Feasibility review stage only		
MAINTENANCE/CLEANING		
None - Feasibility review stage only		
USE		
None - Feasibility review stage only		
DECOMMISSIONING/DEMOLITION		
None - Feasibility review stage only		

© Crown Copyright and Database rights 10023343 2017

Rev.	Date	Purpose of revision	Drawn	Checked	Approved



Chris McCarthy  
Interim Director for  
Infrastructure Delivery  
Environment and Economy  
Oxfordshire County Council  
County Hall  
New Road  
Oxford  
OX1 1ND  
Tel: 0845 310 1111

Project title  
**Connections to Oxford Station**

Drawing title  
**Proposed Taxi Turning Area  
Cornmarket Street**

Drawing Status: Consultation

Scale @ A3	Drawn by	Checked by	Approved by
1:500	SAC		
	Date drawn 11.05.2017	Date checked	Date approved

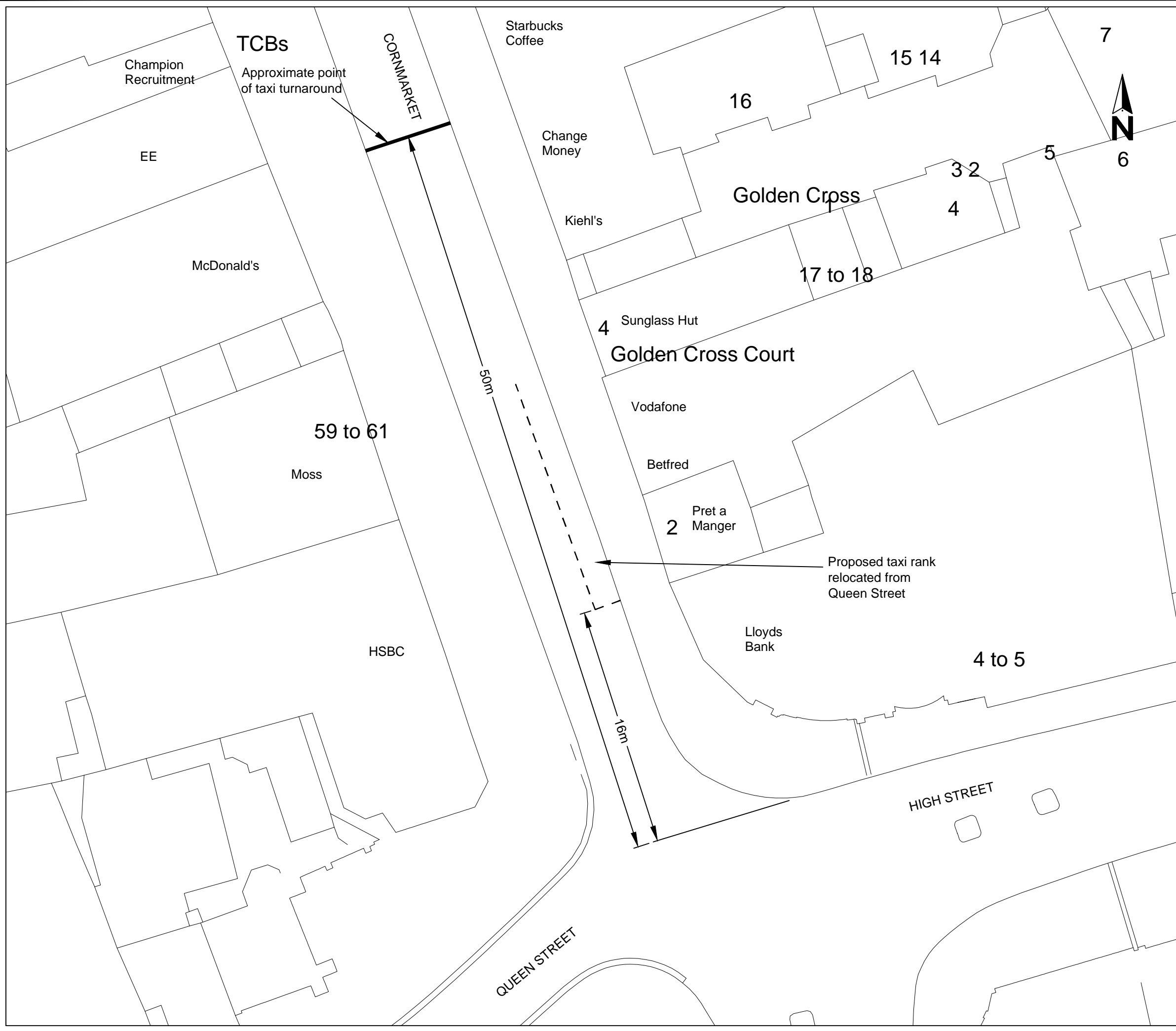

P:\4. Improvement Schemes\201320 Connections to Oxford Station\201320 Part 2 Feb 2017\07 Drawings\05 Working Drgs\201820-CON-000-006 (Cornmarket).dwg

**KEY:**  
 ||||| No waiting, loading or stopping at any time 12:00 - 20:00 hours, except at marked bus stops or loading bays

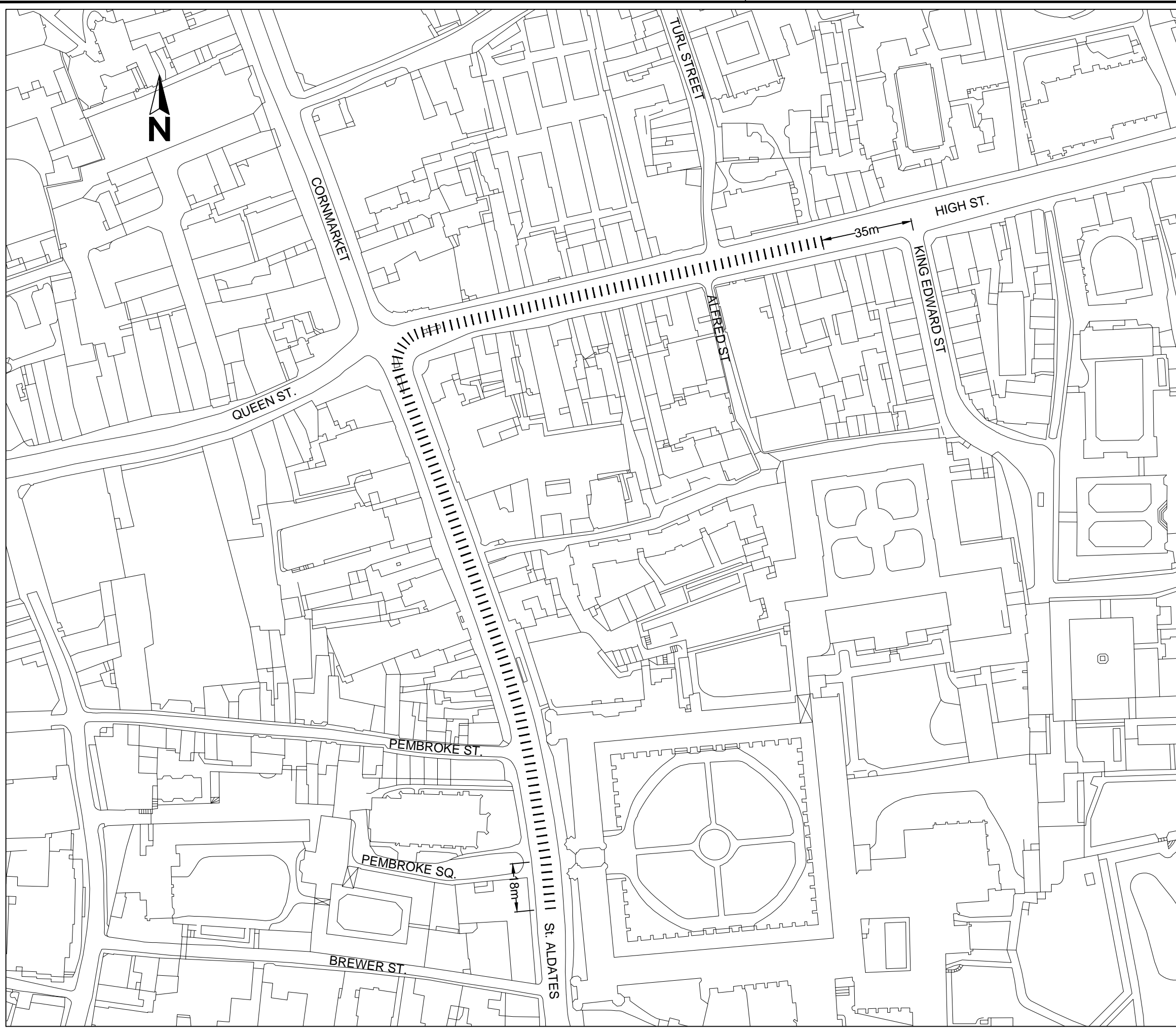

**SAFETY, HEALTH AND ENVIRONMENTAL INFORMATION**

IN ADDITION TO THE HAZARDS/RISKS NORMALLY ASSOCIATED WITH THE TYPES OF WORK DETAILED ON THIS DRAWING, NOTE THE FOLLOWING SIGNIFICANT RESIDUAL RISKS

CONSTRUCTION	(ENTER 'NONE' IF APPLICABLE)
MAINTENANCE/CLEANING	(ENTER 'NONE' IF APPLICABLE)
USE	(ENTER 'NONE' IF APPLICABLE)
DECOMMISSIONING/DEMOLITION	(ENTER 'NONE' IF APPLICABLE)

© Crown Copyright and Database rights 10023343 2017

Rev.	Date	Purpose of revision	Drawn	Checked	Approved

Owen Jenkins  
 Director for Infrastructure Delivery  
 Communities  
 Oxfordshire County Council  
 County Hall  
 New Road  
 Oxford  
 OX1 1ND  
 Tel: 0845 310 1111

Project title  
**Connections To Oxford Station**

Drawing title  
**St. Aldates / High Street  
 Changes to Waiting Restrictions**

Drawing Status: Consultation

Scale @ A3	Drawn by SAC	Checked by	Approved by
NTS	Date drawn 16.05.17	Date checked	Date approved



- KEY:**
- New bus stop
  - New Loading bay
  - New Taxi rank

SAFETY, HEALTH AND ENVIRONMENTAL INFORMATION	
IN ADDITION TO THE HAZARDS/RISKS NORMALLY ASSOCIATED WITH THE TYPES OF WORK DETAILED ON THIS DRAWING, NOTE THE FOLLOWING SIGNIFICANT RESIDUAL RISKS	
CONSTRUCTION	(ENTER 'NONE' IF APPLICABLE)
MAINTENANCE/CLEANING	(ENTER 'NONE' IF APPLICABLE)
USE	(ENTER 'NONE' IF APPLICABLE)
DECOMMISSIONING/DEMOLITION	(ENTER 'NONE' IF APPLICABLE)

© Crown Copyright and Database rights 10023343 2017

Rev.	Date	Purpose of revision	Drawn	Checked	Approved

**OXFORDSHIRE COUNTY COUNCIL**

Owen Jenkins  
 Director for  
 Infrastructure Delivery  
 Communities  
 Oxfordshire County Council  
 County Hall  
 New Road  
 Oxford  
 OX1 1ND  
 Tel: 0845 310 1111

Project title  
**Connections To Oxford Station**

Drawing title  
**High Street  
 Bus, Taxi & Loading Bays**

Drawing Status	Consultation		
Scale @ A3	Drawn by	Checked by	Approved by
1:1000	SAC		
	Date drawn	Date checked	Date approved
	16.05.17		

